

SILVERSAVER[®] 1000

Smart Flatware Detector



SilverSaver[®] 1000 User Manual

Contents

3	SilverSaver® 1000 Parts	11	Ramekins
4	Control Box	12	Cleaning
5	Assembly	14	Batteries and Charging
7	Powering Up the SilverSaver® 1000	16	Troubleshooting
8	Operation	18	Technical Specifications
9	False Alarms	19	Reference Card
10	Tips for Best Results		

SILVERSAVER® 1000

You have purchased the most effective restaurant utensil recovery system in the industry. Please read this operation manual before you start to use your SilverSaver® 1000. It will help you understand its operation, maintenance, and cleaning procedures to ensure maximum savings and years of reliable use.

SilverSaver® 1000 Parts

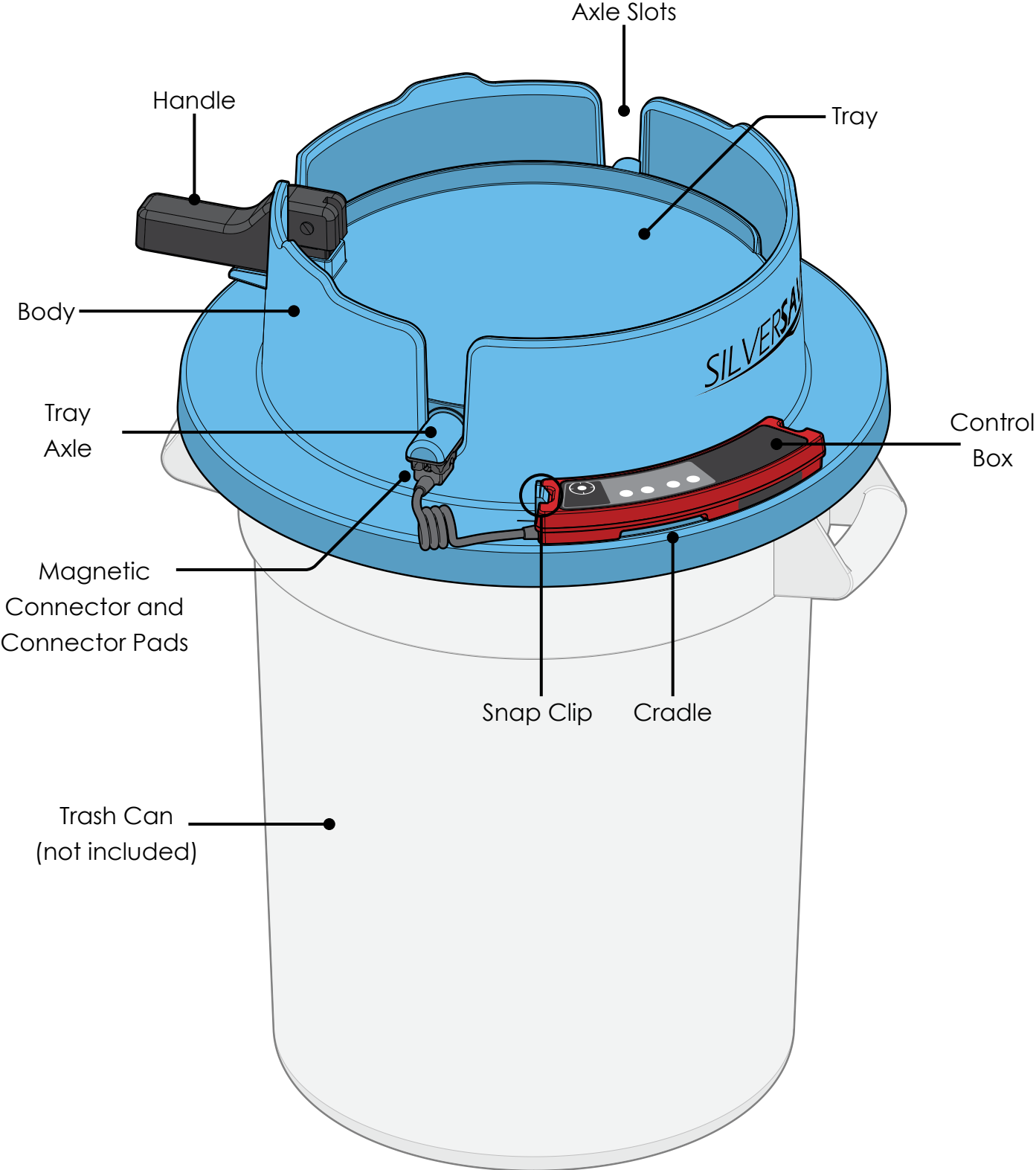

Control Box

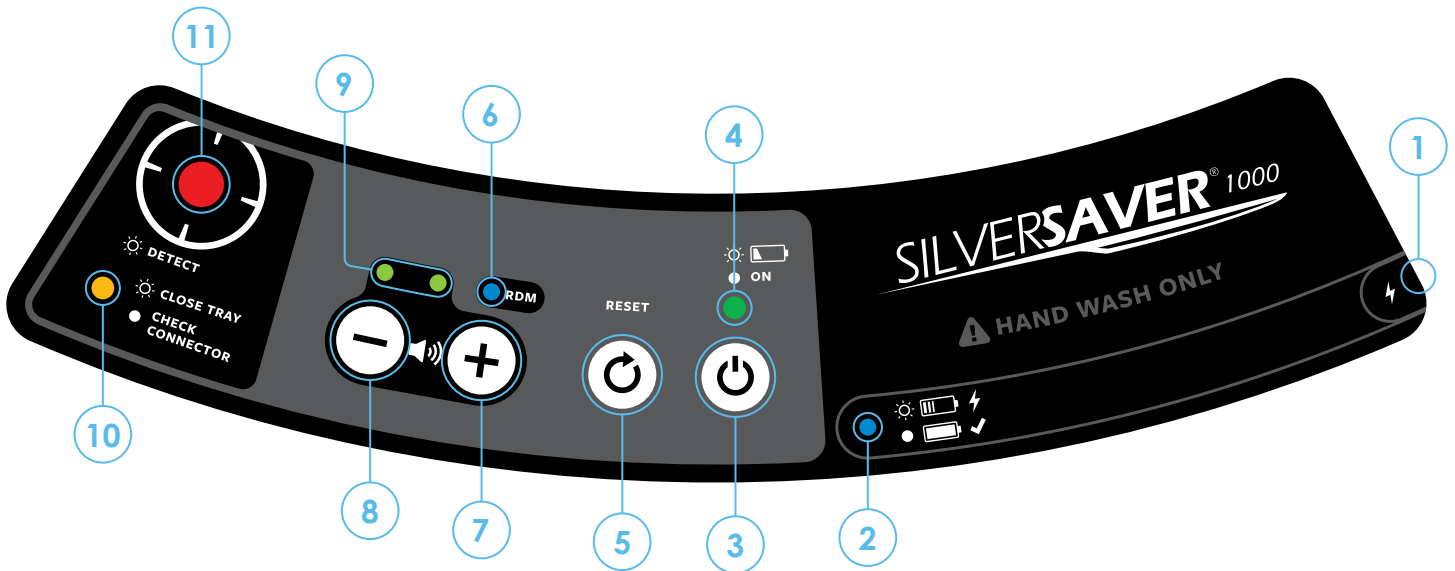

1 Battery Charging Port

2 Battery Charge Status Light (blue)

- ☀ Flashing Charging
- Solid on Charging complete

3 Power On/Off Button

4 Power On/Low Battery Light (green)

- ☀ Flashing Low Battery
- Solid on Power On

5 Reset Button

6 Detection Mode Light (blue)

- Off Full Detection Mode
- Solid on Reduced Detection Mode (RDM)

7 Volume Up Button

8 Volume Down Button

9 Volume Level Lights (green)

- All off Levels 0 and 1
- 1 Solid on Levels 2, 3 and 4
- 2 Solid on Levels 5, 6 and 7

10 Error Light (yellow)

- ☀ Flashing Tray is open
- Solid on Magnetic Connector disconnected

11 Detection Light (red)

- ☀ Flashing Metal object detected

Assembly

1. Place the SilverSaver® 1000 Body on top of a 32 or 44-gallon round trash can.

CAUTION: Use of other trash cans may result in instability and injury!

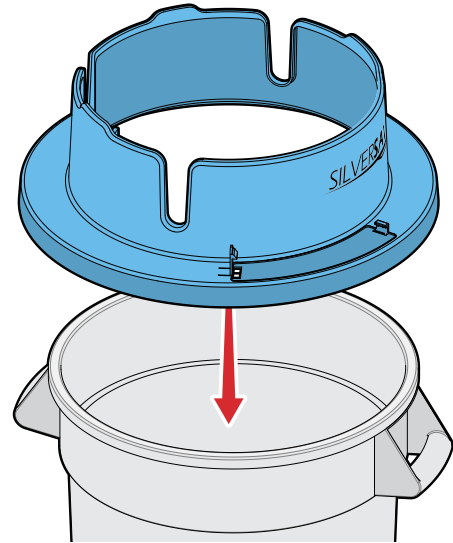

2. Insert the Control Box into the Cradle on the Body by first sliding the right end under the right-side clip.

Then lower the left side of the Control Box until the Snap Clip on the left clicks into place.

CAUTION: Do not bend the Snap Clip back further than necessary as this could break it.

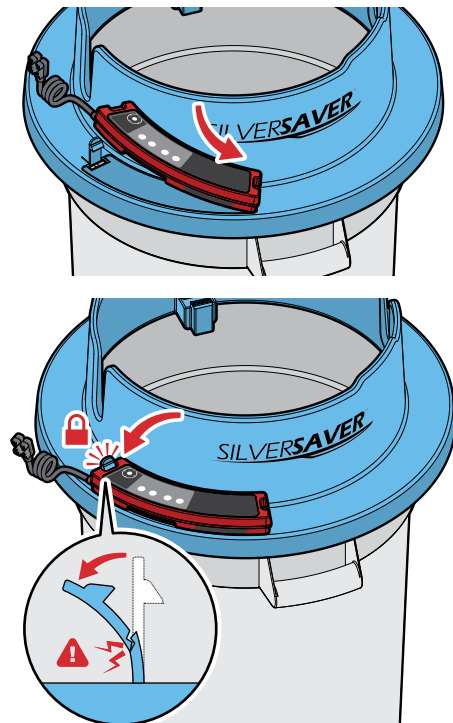

Assembly (continued)

3. Place the Tray in the Body, setting the two Tray Axles into the Axle Slots of the Body.

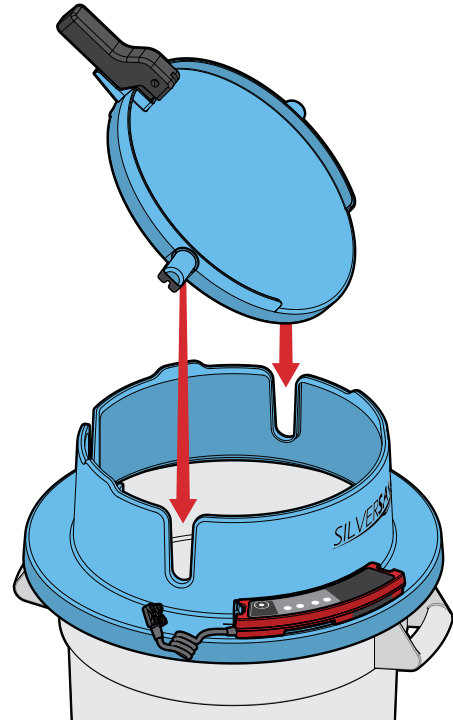

4. Rotate the Tray downward, black side down until a click is heard as the Handle locks into place.

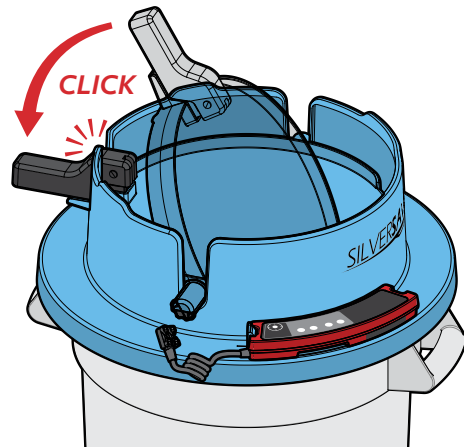

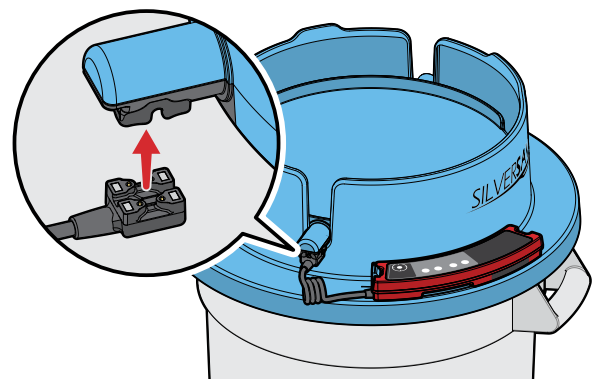

5. Connect the Tray to the Control Box by snapping the Magnetic Connector onto the Connector Pads on the Tray Axle.

Test for a solid connection by pressing lightly down on the cable near the Magnetic Connector to ensure that the Magnetic Connector remains connected.



Powering Up the SilverSaver® 1000





1. Position the trash can so that it is not touching or underneath any metal counters or walls.
2. Ensure Tray is latched, with no metal objects on the Tray.
3. Press  and the Volume Level Lights (green) will begin to flash. The Power On Light (green) will illuminate solid within 2 seconds.
4. Set the volume of the speaker by placing a metal object, such as a fork, on the Tray to activate the alarm. Adjust the volume by pressing  or  buttons until the volume is at the desired level. Remove the metal object.

Operation

1. Be sure the SilverSaver® Tray is in the horizontal and latched position. Empty entire contents of plate onto the Tray.
2. If metal is detected (Detection Light (red) flashes and alarm sounds), remove all metal items from the Tray until the alarm stops.
3. Lift the Handle to tilt the Tray so that the waste falls into the trash can.
4. Return the Tray to the horizontal and latched position.

NOTE: Aluminum foil trash items may activate the alarm. In this case, be sure there are not also any valuable items on the Tray causing the alarm before dropping the waste into the trash can. If foil waste continues to be an issue, please see **'False Alarms'** on page 9.

Lights

Light	Cause	Action
	Metal Detected	Check the Tray for any metal items and remove.
	Tray Open	Return the Tray to the horizontal position with Handle latched.
	Magnetic Connector is Disconnected	Ensure that the Magnetic Connector of the Control Box is securely connected to the Magnetic Pads of the Tray and press the Reset button  If this does not solve the problem, read 'Error Light (yellow) is solid On' on page 16 in the Troubleshooting section for further possible causes and their solutions.
	Low Battery (page 14)	Charge the battery as soon as convenient — see 'Batteries and Charging' on page 14.

False Alarms

When the Detection Alarm is activated but there are no valuable items on the Tray, the cause is usually aluminum foil wrappers, creamer tops, bottle tops, etc.

The SilverSaver® 1000 is initially set to Full Detection Mode, so will detect all metal items that are on the Tray including foil. If detection of scrap foil is a problem, we recommend that supplies with foil be re-sourced to exclude the foil. For example, creamers and butter pats can be purchased with wax paper instead of foil.

If foil detection is still an issue, the situation may be improved by changing the Detection Mode.

Changing the Detection Mode

The SilverSaver 1000® has two Detection Modes — Full Detection Mode and Reduced Detection Mode (RDM).

Full Detection Mode:

If foil products are not commonly found in the waste stream, use Full Detection Mode.

With the unit ON, hold down the Reset button  and then press the Volume Up Button . A rising tone and Detection Mode Light (blue) OFF indicates the unit is now in Full Detection Mode.

Reduced Detection Mode (RDM):

If waste foil is causing frequent false alarms, use Reduced Detection Mode.

With the unit ON, hold down the Reset button  and then press the Volume Down Button . A falling tone and Detection Mode Light (blue) ON indicates the unit is now in Reduced Detection Mode.

NOTE: Due to technology constraints, some types of foil will still be detected even in Reduced Detection Mode.

Tips for Best Results

- Tilt the Tray after each load to make it easier to find valuable items.
- If the SilverSaver® 1000 is moved to a different location, press the Reset button  to quickly re-calibrate for optimum performance in the new location.
- The best way to maximize the cost-saving benefits of the SilverSaver® is to ensure it is used consistently — for this reason, do not leave a spare bagged trash can within easy reach of the cleaning station. This is to discourage use of a trash can that does not have a SilverSaver® attached. Never allow any waste to enter the trash can without passing through the SilverSaver®.

Ramekins

Ramekin Savers are adhesive labels that can be applied to the underside of non-metallic ramekins and other non-metallic valuable items so that they can be detected by the SilverSaver® 1000. Ramekin Savers are specifically designed and manufactured to maximize detection and to maintain strong adhesion for thousands of wash cycles in high-pressure dishwashing machines and when exposed to high temperatures.

Some sample Ramekin Savers are supplied with the SilverSaver® 1000. Additional Ramekin Savers are available for separate purchase.

Applying Ramekin Savers to Ramekins

1. Thoroughly clean and dry the ramekins. Pay special attention to the base where the Ramekin Saver will be applied.



2. Remove the backing from the Ramekin Saver label, being careful not to get fingerprints on the adhesive.

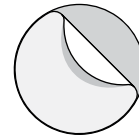

3. Apply the Ramekin Saver to the clean and dry base of the ramekin.

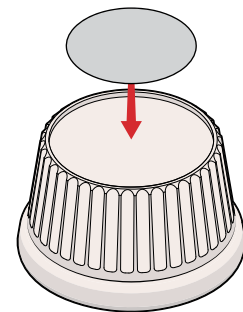

4. Press down firmly over the entire Ramekin Saver, especially at the perimeter.

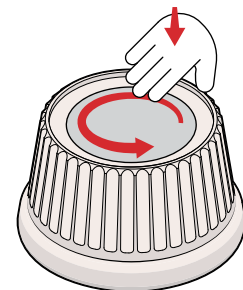

Cleaning

Cleaning the Control Box

⚠ CAUTION: DO NOT CLEAN THE CONTROL BOX IN A DISHWASHING MACHINE. THIS WILL DAMAGE THE ELECTRONICS AND VOID YOUR WARRANTY!

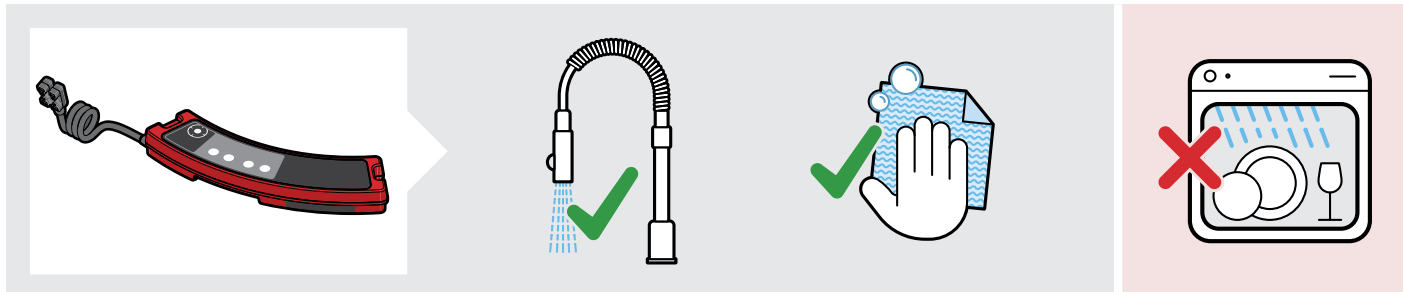

1. Ensure the SilverSaver® 1000 is turned off.

2. Disconnect the Control Box from the Tray. To do this, slide the Magnetic Connector directly away from the Tray until it releases.

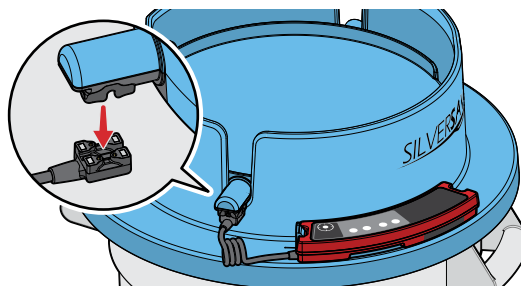

3. Remove the Control Box by gently pulling back the left Snap Clip while lifting the Control Box from the left.

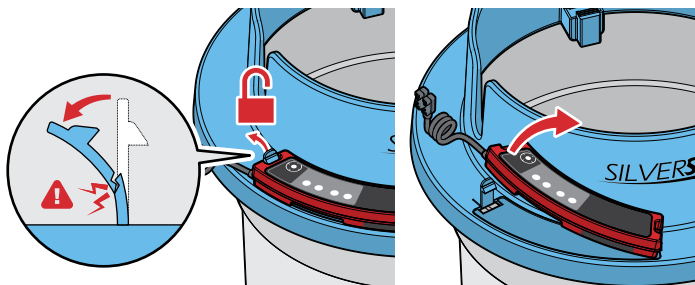

4. Wash the Control Box in warm running water. Use soapy water and a soft cloth or brush for greasy or sticky residue. Pay special attention to the connector pads and Magnetic Connector, speaker grill, and battery charging port to ensure there is no build-up of food residue that may prevent a clear connection or muffle the sound.

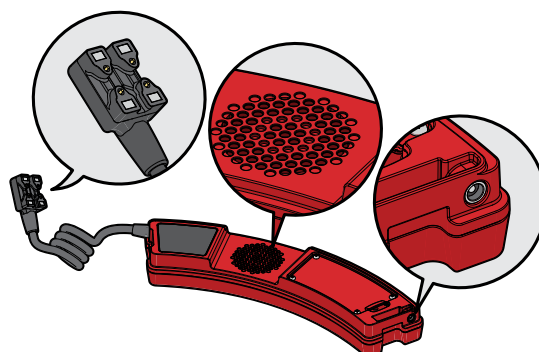

Cleaning (continued)

5. After washing, dry the control box and the Magnetic Connector with a dry cloth. Blow excess water out of the Battery Charging Port.
6. After this cleaning procedure is complete, charging the Control Box overnight is recommended to ensure a full charge for the following day.

Cleaning the Tray

The tray may be washed in a commercial dishwasher or hand washed in the sink.

Detergent and the sprayer commonly found in commercial sinks will not damage the tray, but abrasive scrubbers may scratch the plastic and cause food waste to more readily stick to the surface.

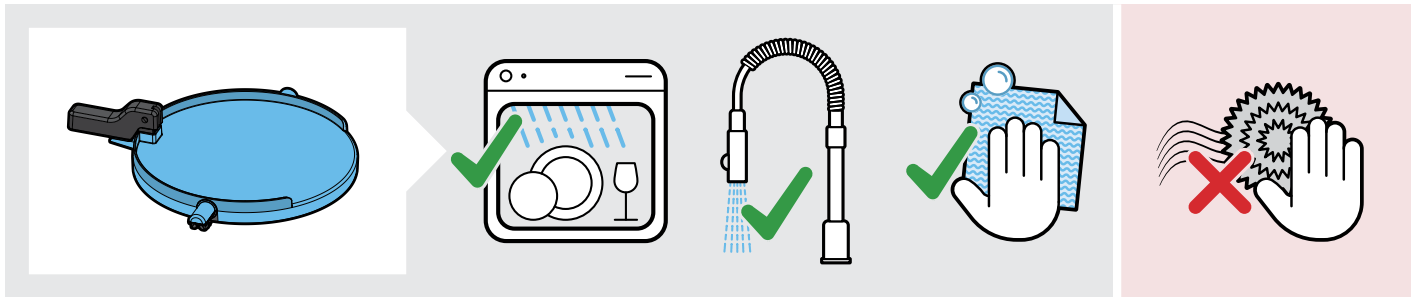

Cleaning the Body

Hand washing of the Body is recommended, as it is too large to fit into the typical dishwashing machine without being damaged.

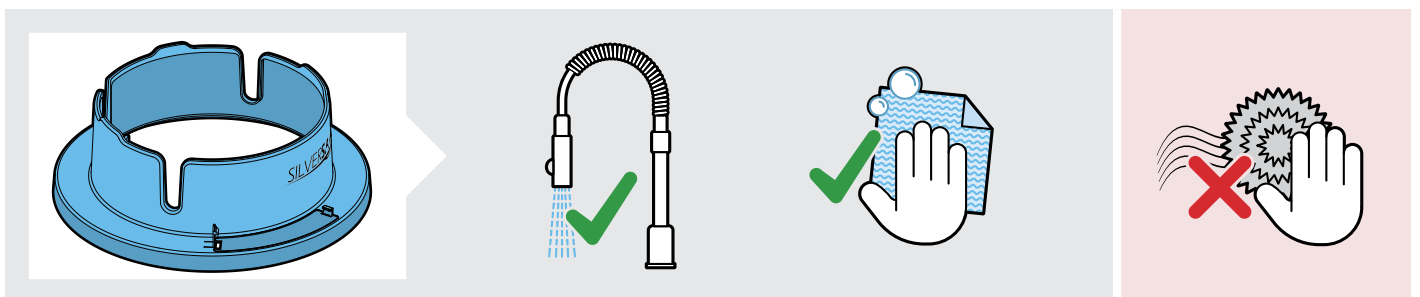

Batteries and Charging

Low Battery Alarm

When the battery is running low, the Power On/Low Battery Light (green) will start flashing and a Low Battery audible alarm will sound every 30 seconds.

The SilverSaver® 1000 will indicate the Low Battery state when there is 10% or less charge remaining. The unit will continue to run normally while in the Low Battery state until the battery is fully depleted.

Charging the Battery

Unless your Control Box is permanently connected to an electricity source, we recommend you establish a charging location which is free from moisture (such as the manager's office), and to charge the battery once a day.

1. Connect the AC adaptor into the Battery charging port and then into an electrical outlet.

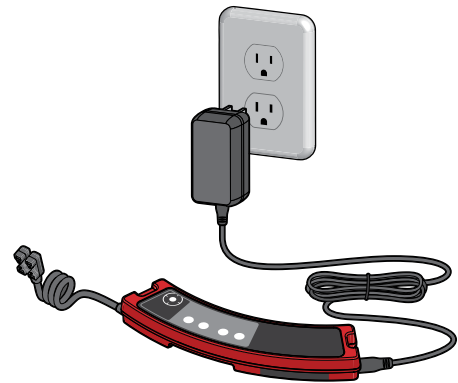

2. Once the battery is fully charged, the Battery Charge Status Light (blue) will stop flashing and will remain steady on until the AC adaptor is disconnected.



NOTE: It is recommended that the battery be charged every night, even though the Power On/Low Battery Light may not be flashing.

NOTE: The SilverSaver® can continue to be used during charging. Follow the safety advice listed in “[AC Adaptor and Battery Safety](#)” on page 15 to ensure this is done safely.

Batteries and Charging *(continued)*

AC Adaptor and Battery Safety



Caution must be used when handling the SilverSaver® 1000 AC Adaptor.

Carefully follow the advice listed.

⚠ WARNING:

- Risk of explosion if battery is replaced by incorrect type.
- If operating the SilverSaver® 1000 during charging, cables must be routed to avoid tripping hazards. All electrical connections must be waterproofed for the kitchen environment.
- Do not allow children to play with the SilverSaver® 1000.
- Do not open or mutilate the internal batteries.
- Dispose of batteries as per local regulations.
- Only charge the Control Box according to the instructions in this manual.
- Only use the supplied AC adaptor to charge the Control Box.
- Unplug the AC adaptor from the power supply when not in use.

Troubleshooting

Problem	Error Light (yellow) is flashing
Cause	The Tray has been left open for longer than 4 seconds.
Solution	<ol style="list-style-type: none">1. Close the Tray, ensuring the Handle correctly latches.2. If the problem persists, Reset the Control Box by pressing the Reset Button.3. If the problem continues, contact a Service Center for repair.
Problem	Error Light (yellow) is solid On
Cause 1	The Tray is disconnected.
Solution	Ensure that the Magnetic Connector of the Control Box is securely connected to the Magnetic Pads of the Tray and press the Reset button  .
Cause 2	The Tray connector is dirty or wet.
Solution	Clean and dry the Magnetic Connector on the Control Box Cable, then connect it securely to the Magnetic Pads on the Tray Axle. Press the Reset button  .
Cause 3	There is an System Error.
Solution	Turn the Control Box off and then back on by pressing the Power Button. If the problem persists, contact a Service Center for repair.
Problem	Control Box will not turn on
Cause	Battery is totally discharged
Solution	Charge the battery. To test, connect the Control Box to the supplied AC adaptor and then turn on the Control Box. If the problem persists, contact a Service Center for repair.

Troubleshooting (continued)

Problem	Detection Light and alarm sounds constantly, even with no metal sitting on the Tray
Cause 1	Waste items such as creamer tops look like paper but actually have aluminum foil in them and are being detected.
Solution	<ol style="list-style-type: none">1. Where possible, re-source those items and purchase alternatives that don't include foil.2. Remove those items temporarily from the Tray so that the alarm stops, indicating that no other items are activating the alarm.3. Try switching the Detection Mode to 'Reduced Detection Mode' (see 'False Alarms' on page 9).
Cause 2	The SilverSaver® is detecting metal from another location.
Solution	Reset the Control Box and wait for the Volume Level Lights to stop flashing (approximately 5 seconds).
Problem	Battery Charge Status Light will not stop flashing
Cause	Battery is damaged or cannot charge.
Solution	<p>Ensure ample time has been allowed for battery to fully charge (6 hours if Control Box is powered off, 10 hours if operating during charging). If it has, turn the Control Box off and then back on.</p> <p>If the problem persists, contact a Service Center for repair or a replacement battery.</p>
Problem	Battery run time is short
Cause	Battery is damaged or cannot hold charge.
Solution	<p>Turn the Control Box off and then back on.</p> <p>If the problem persists, contact a Service Center for repair or a replacement battery.</p>

Technical Specifications

AC Adaptor	Input: 110 to 240 VAC, 0.5 A Max, 50 / 60 Hz Output: 5 V DC, 2.0 A, 10 W
Rechargeable Battery	Lithium Ion 3.7 V, 5000 mAh
Charging Time	5 to 6 hours using the supplied AC Adaptor. This will be longer if the Control Box is in use during charging.
Battery Run Time	Over 24 hours based on average usage intensity
Volume Adjustment	8 Levels
Tray	Waterproof, IP68
Control Box	Water resistant, IP57
Operating Temperature	+14°F to +104°F (-10°C to +40°C)
Storage Temperature	-4°F to +158°F (-20°C to +70°C)
Weight	Tray Assembly: 4 lb 6 oz (2 kg) Control Box: 13 oz (370 g) Body: 1 lb 2 oz (500 g)

Trademarks

SilverSaver® is a trademark of Minelab Electronics Pty Ltd.

Disclaimer

Equipment may vary according to the model or items ordered with your SilverSaver® 1000. SilverSaver® reserves the right to respond to ongoing technical progress by introducing changes in design, equipment and technical features at any time.

For the most up-to-date specifications for the SilverSaver® 1000, visit www.GetSilverSaver.com

Reference Card

-  Ensure there are no metal items on or under the Tray, then power on the SilverSaver® by pressing the Power Button.

- Scrape all table scraps onto tray.

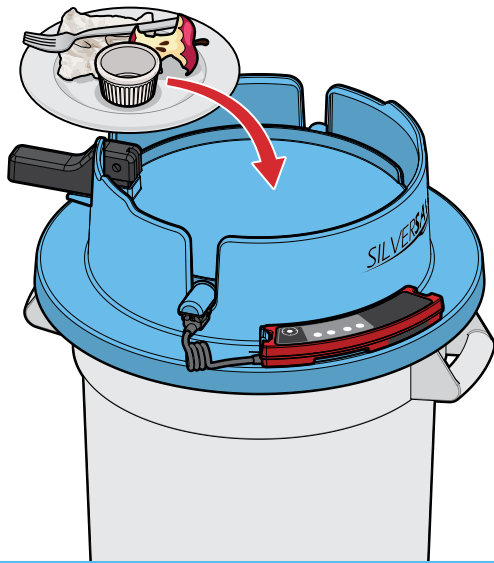

- If Detection alarm is activated, look for and remove valuables.

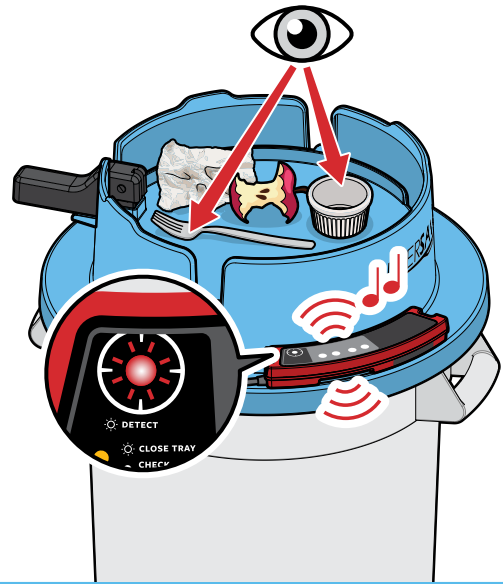

- Lift handle to dispose.

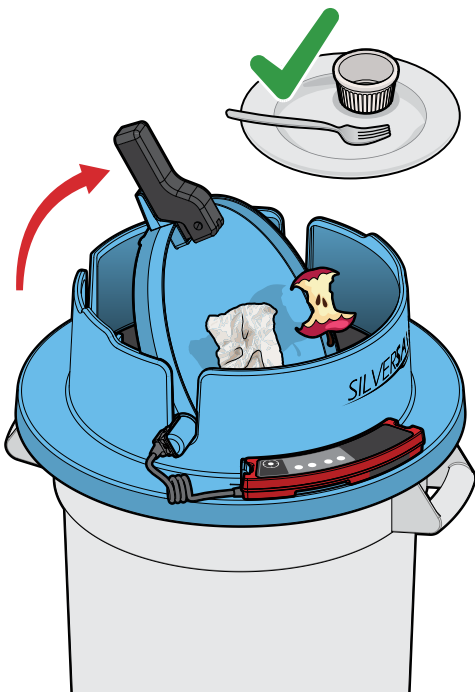

- Always return tray to original position (horizontal).

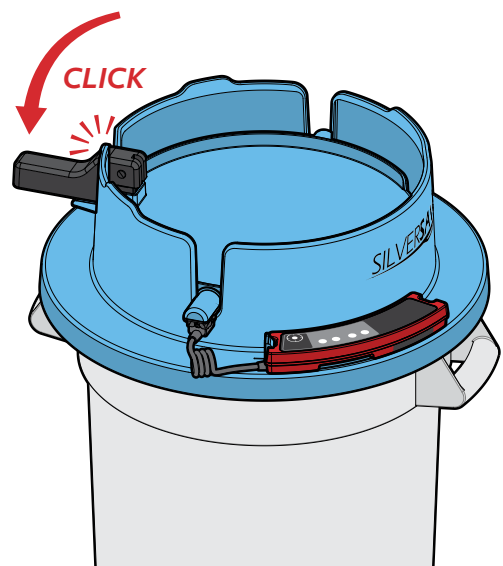

SILVERSAVER[®] 1000

4901-0375-3

Contact 1-877-767-6522 | mail@GetSilverSaver.com www.GetSilverSaver.com